

## Mounting Dimension

## T908B

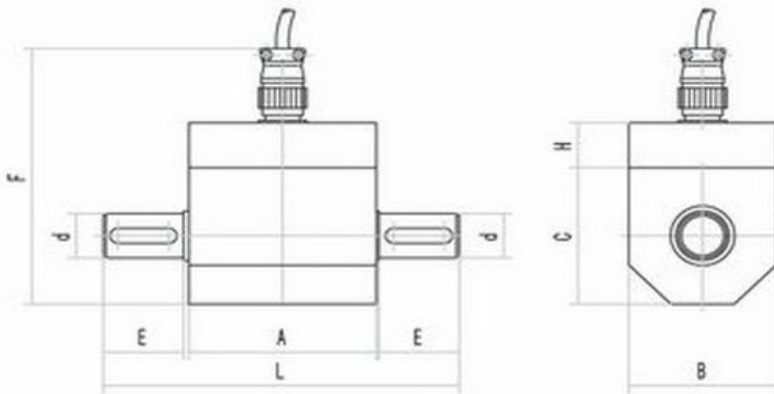

Cap (N.m)	d	L	E	A	F	C	B	H	
5,10,20,50,100	18	133	30	70	101	55	55	18	25×6×6
200,500	25	155	30	91	115	65	65	18	30×8×7

Specifications	Technique
Capacity	5,10,20, 50,100,200,500Nm
Rated output	1.0~1.5mV/V
Zero balance	±1% F.S.
Non-linearity	0.2%F.S.
Hysteresis	0.2%F.S.
Repeatability	0.1%F.S.
Creep(30min)	0.1%F.S.
Temp.effect on output	0.05%F.S./10°C
Temp.effect on zero	0.05%F.S./10°C
Input impedance	350/700±10Ω
Output impedance	350/700±10Ω
Insulation	≥2000MΩ/100VDC
Recommended excitation	±15V(output frequency signal)
Recommended excitation	24V (output analog signal)
Compensated temp range	-10~60°C
Operation temp range	-20~60°C
Safe overload	120%F.S.
Ultimate overload	150%F.S.
Cable size	3m
IP Class	IP66

## Features &amp; Applications

- Constituted by Strain gauge sensitive components and integrated circuits;
- High precision with stable and reliable performance;
- This sensor can be operated long-term in high-speed without wear ring and other wear parts, the output is OK for positive and negative torque signal;
- Both ends are keyed;
- Maximum speed of torque cannot over 8000 r / min.

## Wiring Code

